Monmouth Elementary/Middle School Percents For Arts Proposal

Maine artists David Hurley and Peter Walls Propose for location #3, main hallway 50'+ , with various height dimensions a series of shaped panel murals that will visually activate that particular length of the corridor hallway. We have also included three additional panel ideas to be considered with separate budgets to further activate the entire hall length. The rich history of Monmouth has always had a strong focus on farming, nature, and community. Our shaped panels would focus on the rich imagery associated with farming and the natural world. These would be visually fun , colorful, and exciting for the Pre-K- Grade 8 student body.

Four “Murals” composed of multiple panels activate the almost 70' section of wall to the left of the cafeteria hall entrance. From left to right each has a core theme that transitions to the next. (*See coinciding elevation drawings with measurements in your packet).

- Mural # 1 (Barn and cow in landscape). A bright and colorful interpretation of this view of the Jersey Cow with path leading up to the barn atop the hill use cut-out panels to activate the wall and break the grid; Very much reminiscent of classic children's books and/or puzzles. Additional details such as flowers, insects, and other animals will be integrated into this combustion during the next design phase.
- Mural # 2 (Lake view with canoe) Like Mural #1 cut out forms create this view of the classic lake scene with bold composition and landscape elements that allow the students to imagine their immersion in the outdoors. The element of “forest bathing” would be included here. Featuring a landscape setting of a lake with wildlife including ducks, loons, osprey, and fish that transport the students to the natural world in their shuffle between classes. Bright and exaggerated use color in these “cut-out” panels will mimic storybook views of nature.
- Mural #3 (Chickens and Dog with Egg) This third panel transitions from the lake scene to a close up of the child with hens and the small dog running off with an egg. The panels simplify to a larger shape mural with a smaller cloud or two moving from the lake scene to this one. Again, painted in a Fun, Bold, and Colorful style the panels will activate the space with a farm narrative.
- Mural 4 (Woman with Sunflower and Child) This Fourth Panel is the largest with the slope of the hall reaching 12'+ in height before the entrain hall to the Cafeteria. The Female Farmer with her child stand within a “pollinator” garden with sunflowers reading to the ceiling. She carries a basket of harvested onions. There will be colorful wildflowers and milkweed plants and pods with some monarch butterflies . Women Farmers are not only a part of Maine's rich agricultural heritage but are also increasing in numbers. Locally sourced food and farmed products play a key element in strengthening the community and will become even more important in Maine's future.

Monmouth Elementary/Middle School Percents For Arts Proposal

If these concept studies are approved David and Peter have allowed for 80 hours (40 hours each) in their attached budget for further photographing of models and finalizing current and additional drawings to flush out each section of the mural. This includes creating final shape definition for each panel.

All of the panels would allow David and Peter to collaborate together as well as opportunities to paint together much like musicians each bringing their own skills and views of the world into each and every panel. The long hallway would always be bright and welcoming, whether a single student or large group were passing through, with an abstracted and highly colorful play of landscape panels slowly morphing into more traditionally situated, but still shaped panels that would include more figurative views of farm related activities. It is in this transition of panels where David and Peter merge their styles, (** See PCHC Pediatric Center Mural for example **). Each of them working into, on, and around each panel. We believe this creates an even more dynamic work of Art than one person alone would create. The linear “Hallway” scenario format itself to this as you slowly view each piece as you move through the hall allowing for change to occur in style and color from one end to the other. Our ultimate goal is for a Work of Art greater than the sum of its parts!

The shaped panels are cut from half-inch 4’x8’ MDO paper coated panels, triple primed and painted with acrylic paints. The murals are triple coated with high gloss acrylic that gives a bright sheen along with a protective coating. Would would attach the panels directly to the wall using tamper resistant safety fasteners.

Peter has been involved with large decorative painting, mural, and interior design projects for the past 25 years and his knowledge of project management and project planning continue to drive his current projects and Studio Art. David and Peter recently completed an exterior shaped mural for the new PCHC Pediatric Center in Bangor, Maine. David has used this technique to great success on a series of murals for the United Farmers Market in Belfast, Maine.

David’s four large scale murals on the exterior of the United Farmers Market in Belfast feature a giant carrot (17’) a red leaf of lettuce (22’) a pea pod with peas rolling away (30’) and a chicken with seven baby chicks (14’) titled “Big momma chicken and the seven magnificent chicks.” The shaped panels creatively expand the traditional rectangular and square shapes of murals.

 Monmouth Elementary/Middle School Percents For Arts Proposal
BUDGET

Design Set-Up Fee to create final drawings and transfer to panels

80 hours @ \$25 pr/hr -\$2000.00 divided equally between each Artist

Peter Walls - \$ 1000.00

David Hurley - \$ 1000.00

13 sheets 1/2" One side Paper Coated MDO - \$52.75 each (as of 8/13/20)

- \$ 685.75

4 Gallons INSLX - STIX latex/epoxy primer - \$54.01 each (as of 8/13/20)

- \$ 216.04

2 Gallons Liquitex Gloss Acrylic Varnish. - \$100.33 each (as of 8/13/20)

- \$ 200.66

20 Quarts of Benjamin Moore Aura 100% Acrylic Interior Coating - \$36.91 each

- \$ 738.20

250 Tamper Proof Soft edge Hangers/fasteners Screws

- \$ 75.00

Labor (preparation, painting of panels)

- \$ 13,500.00

divided equally between each Artist

Peter Walls - \$ 6750.00

David Hurley - \$ 6750.00

2 Days - Delivery and Installation

- \$ 600.00

** Does not include an on-site maintenance for verification of screw placement **

Total - \$ 17,475.65

** \$ 8737.83 per Artist

Monmouth Elementary/Middle School Percents For Arts Proposal

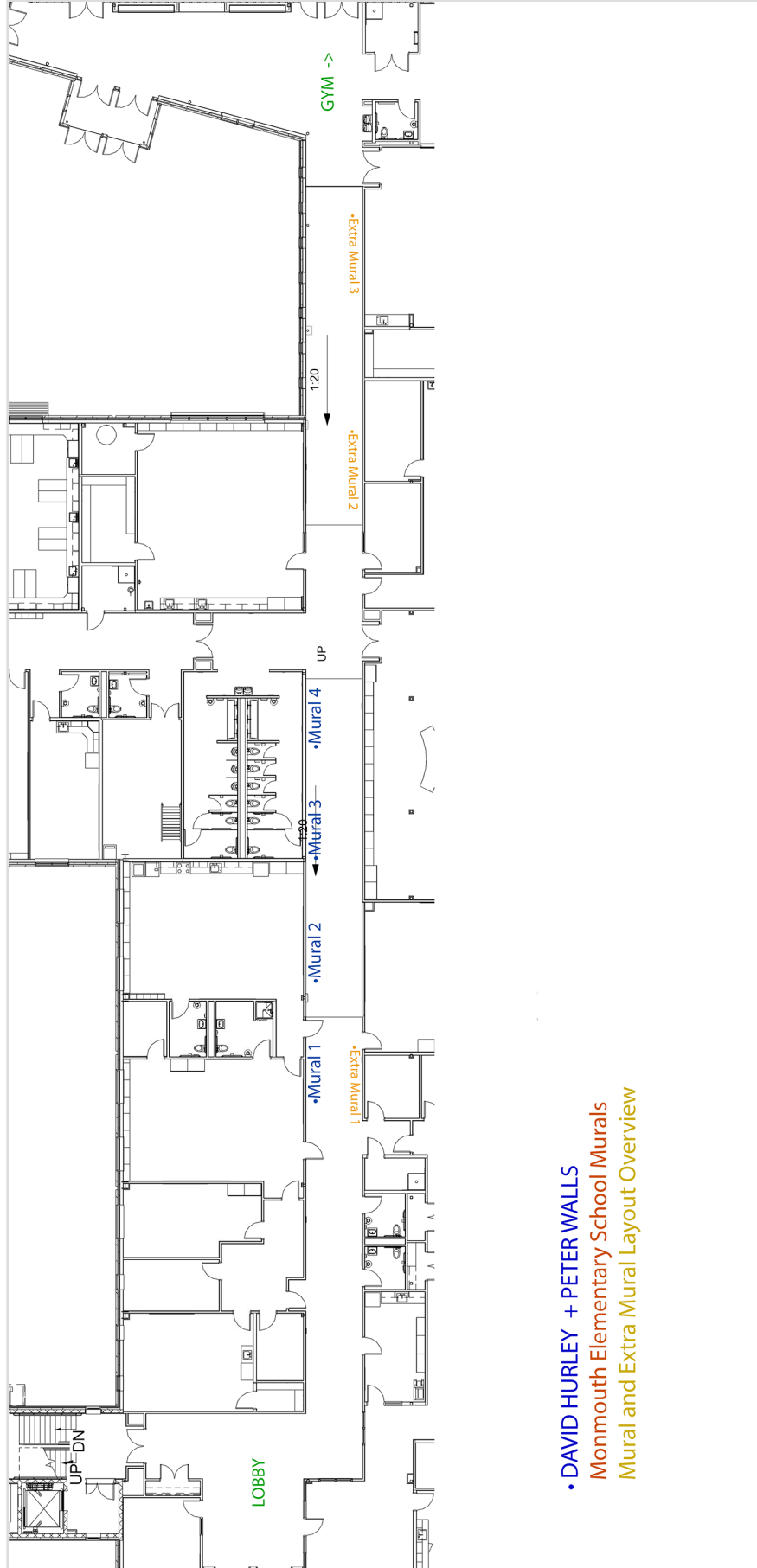

- DAVID HURLEY + PETER WALLS
Monmouth Elementary School Murals
Mural and Extra Mural Layout Overview

Monmouth Elementary/Middle School Percents For Arts Proposal

• DAVID HURLEY + PETER WALLS
Monmouth Elementary School Murals
Mural Layout Overview

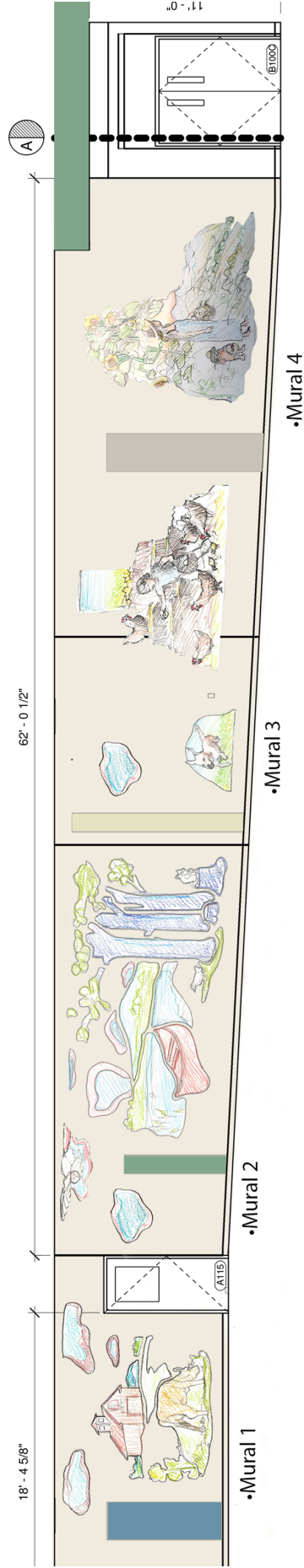

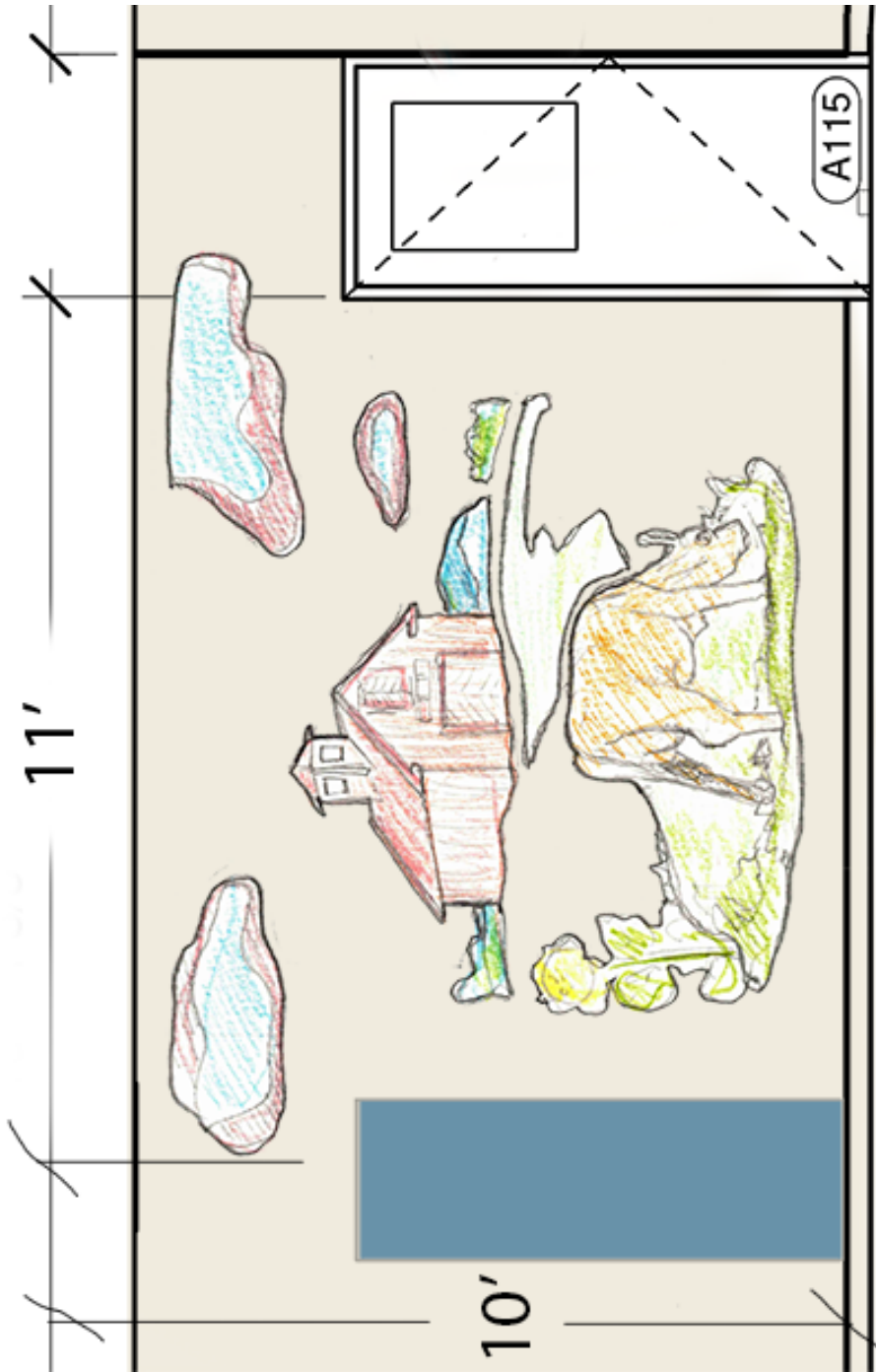

•Mural 1

Monmouth Elementary/Middle School Percents For Arts Proposal



Monmouth Elementary/Middle School Percents For Arts Proposal

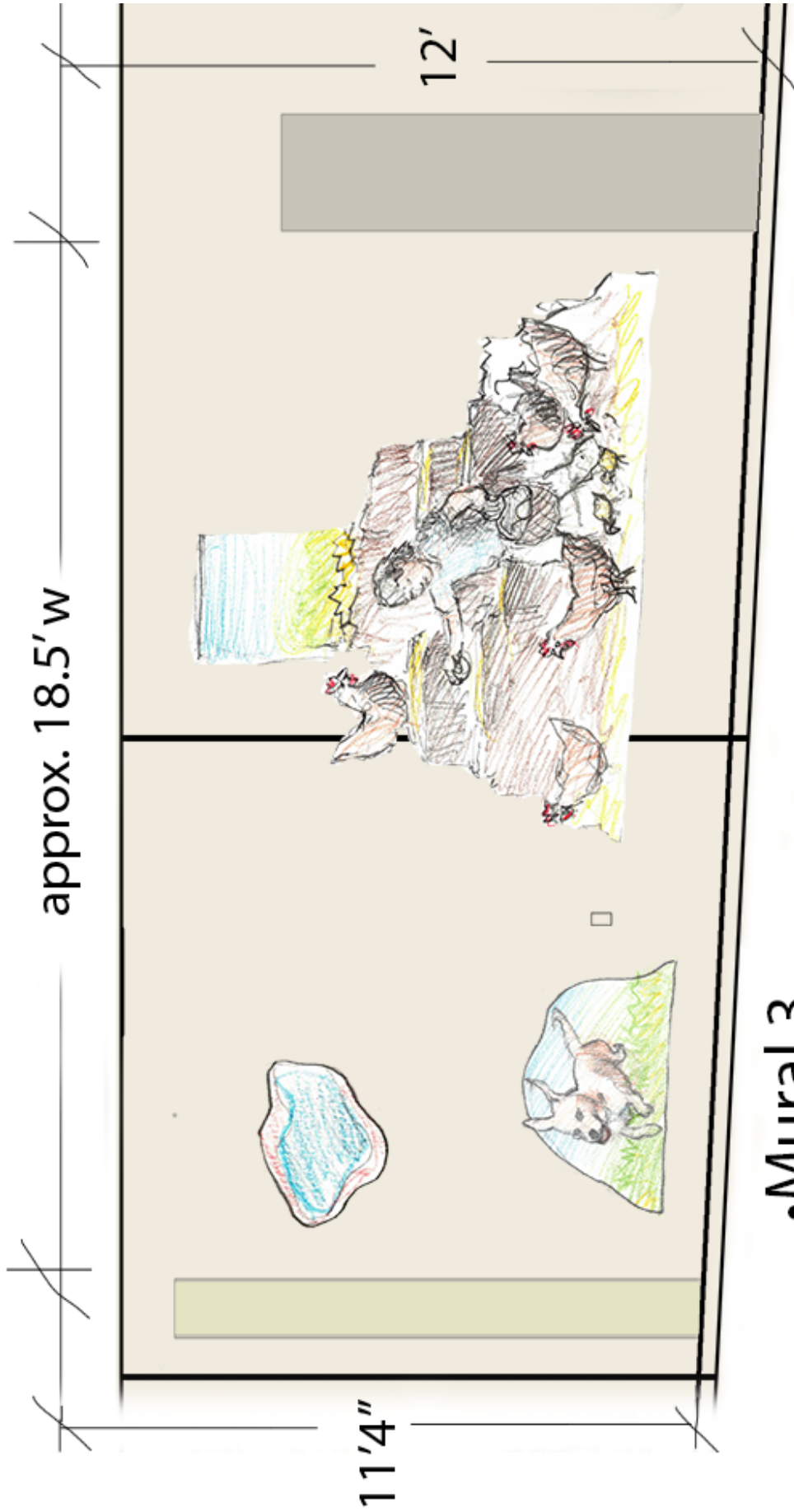

•Mural 3



•Mural 4

Monmouth Elementary/Middle School Percents For Arts Proposal

REFERENCE MATERIALS

David and Peter use photographic reference materials that they shoot themselves as well as in-situ drawing and painting to gather their imagery. Design and layout happens organically through this organization of materials that relate to their overall concept- In this case Farming and the Landscape of Monmouth Maine. The pre-existing neutral wall color, Sherwin Williams 7565 - Oyster Bar, will allow us to use bright intense colors in order to visually stand off the wall color. Their budget allows for an additional week, 80 hours, to complete this visual research and create final drawings for transfer to the shaped mural panels. The images below are the first stage of this process and will be refined during this next week of research and development.



Monmouth Elementary/Middle School Percents For Arts Proposal

1



MONARCH BUTTERFLY



Monmouth Elementary/Middle School Percents For Arts Proposal



Monmouth Elementary/Middle School Percents For Arts Proposal

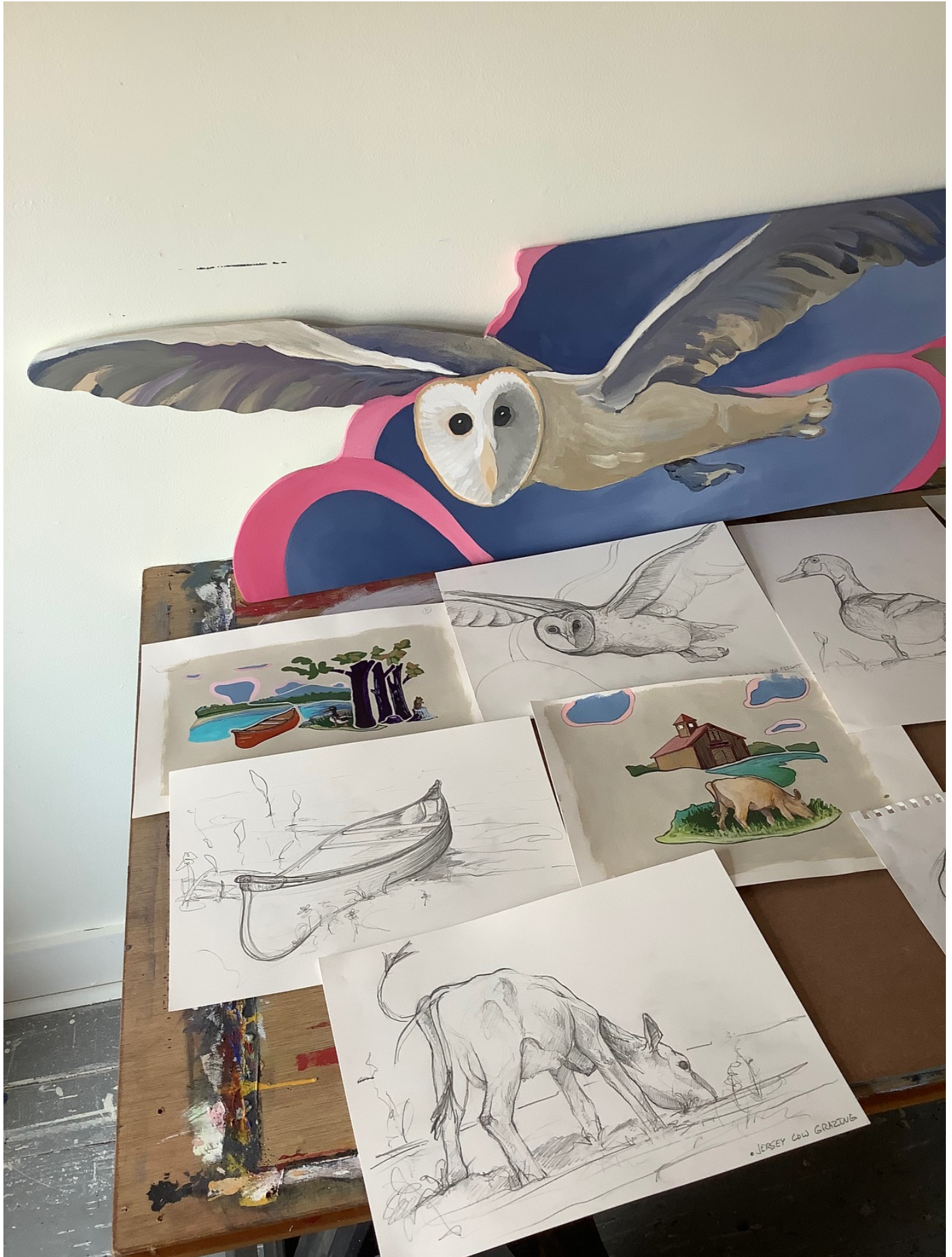

Monmouth Elementary/Middle School Percents For Arts Proposal

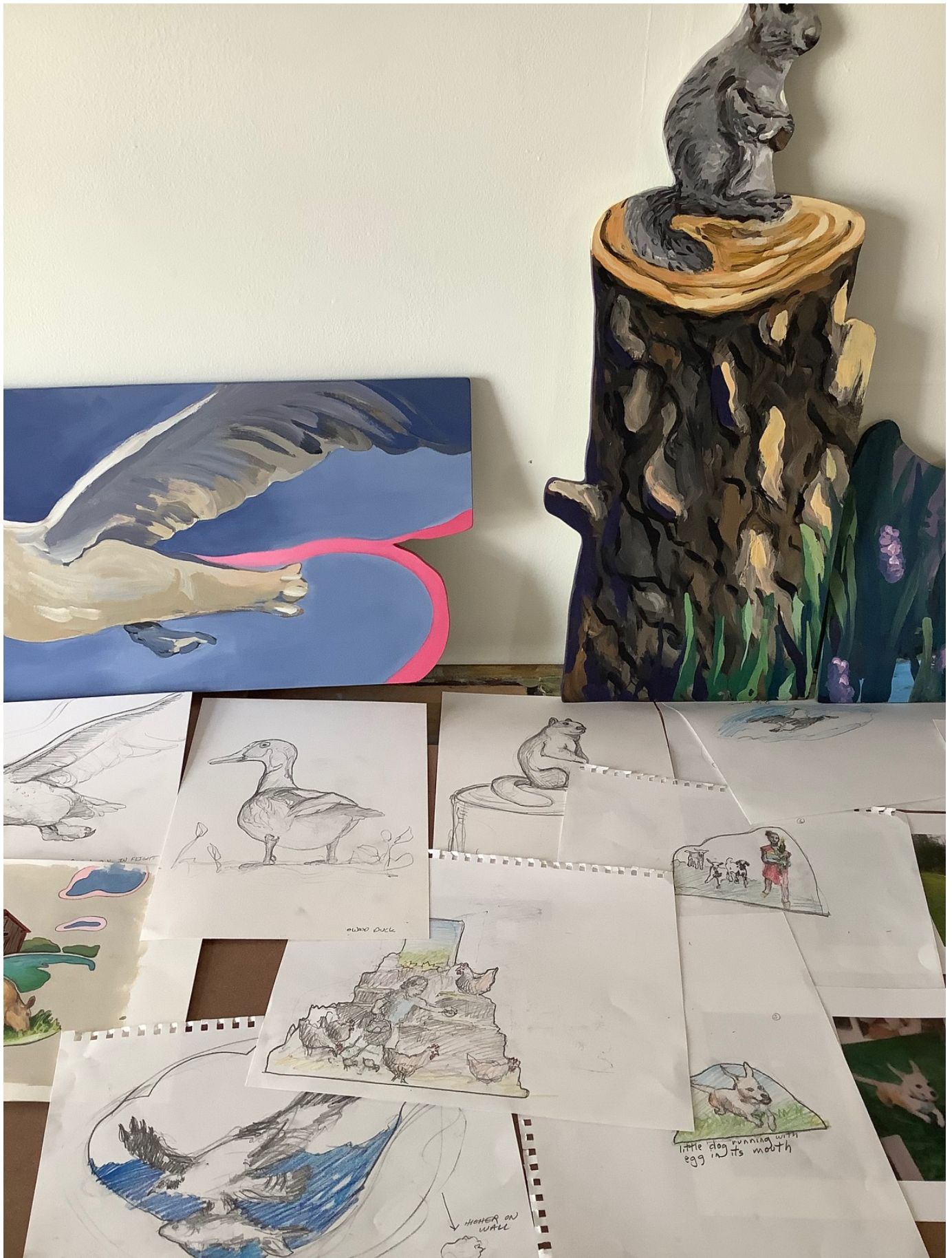

Monmouth Elementary/Middle School Percents For Arts Proposal

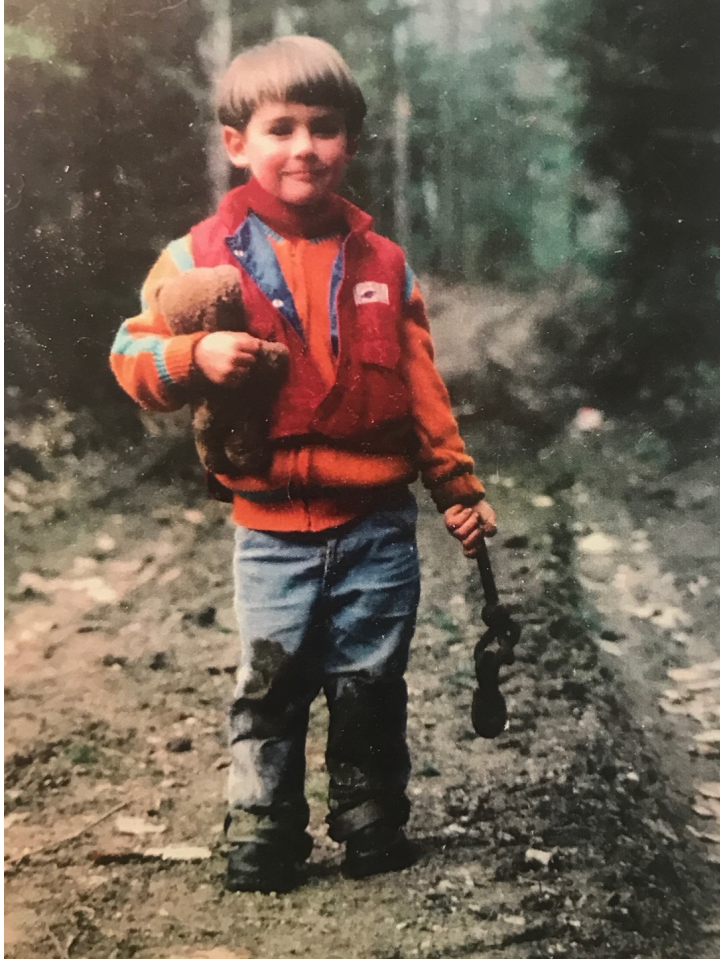

Monmouth Elementary/Middle School Percents For Arts Proposal

MATERIALS

David and Peter paint on 1/2" Paper Coated MDO Plywood. It has great stability, cuts easily, and when properly primed on all sides and edges created a great "canvas" for their work. They use Benjamin Moore's top tier Aura line of Interior/Exterior Paint and triple varnish with Liquitex Brand High Gloss UV stable Varnish. The high gloss bringing out all of the great color work they use in their work.



 Monmouth Elementary/Middle School Percents For Arts Proposal

Addendum : Additional Mural Proposals

After a site visit and reviewing the hallway we have decided to include these three additional three murals for consideration. We have placed them in locations on the opposite side of the hallway to further lead you visually down the hallway.

- **Additional Mural #1** (Girl holding Corn leading Goats). Young African American Girl holding Corn leads goats toward the viewer with a smaller shaped panel with a goose flying above.

BUDGET for Additional Mural #1

Design Set-Up Fee to create final drawings and transfer to panels

80 hours @ \$25 pr/hr -\$250.00 divided equally between each Artist

Peter Walls	- \$	125.00
-------------	------	--------

David Hurley	- \$	125.00
--------------	------	--------

2 sheets 1/2" One side Paper Coated MDO - \$52.75 each (as of 8/13/20)

	- \$	105.50
--	------	--------

1 Gallon INSLX - STIX latex/epoxy primer - \$54.01 each (as of 8/13/20)

	- \$	54.01
--	------	-------

1 Gallon Liquitex Gloss Acrylic Varnish. - \$100.33 each (as of 8/13/20)

	- \$	100.33
--	------	--------

8 Quarts of Benjamin Moore Aura 100% Acrylic Interior Coating - \$36.91 each

	- \$	295.28
--	------	--------

50 Tamper Proof Soft edge Hangers/fasteners Screws

	- \$	15.00
--	------	-------

Labor (preparation, painting of panels)

	- \$	3600.00
--	------	---------

divided equally between each Artist

Peter Walls	- \$	1800.00
-------------	------	---------

David Hurley	- \$	1800.00
--------------	------	---------

1 Day - Delivery and Installation

	- \$	300.00
--	------	--------

** Does not include an on-site maintenance for verification of screw placement **

Total **- \$ 4720.12**

** \$ 2360.06 per Artist

Monmouth Elementary/Middle School Percents For Arts Proposal

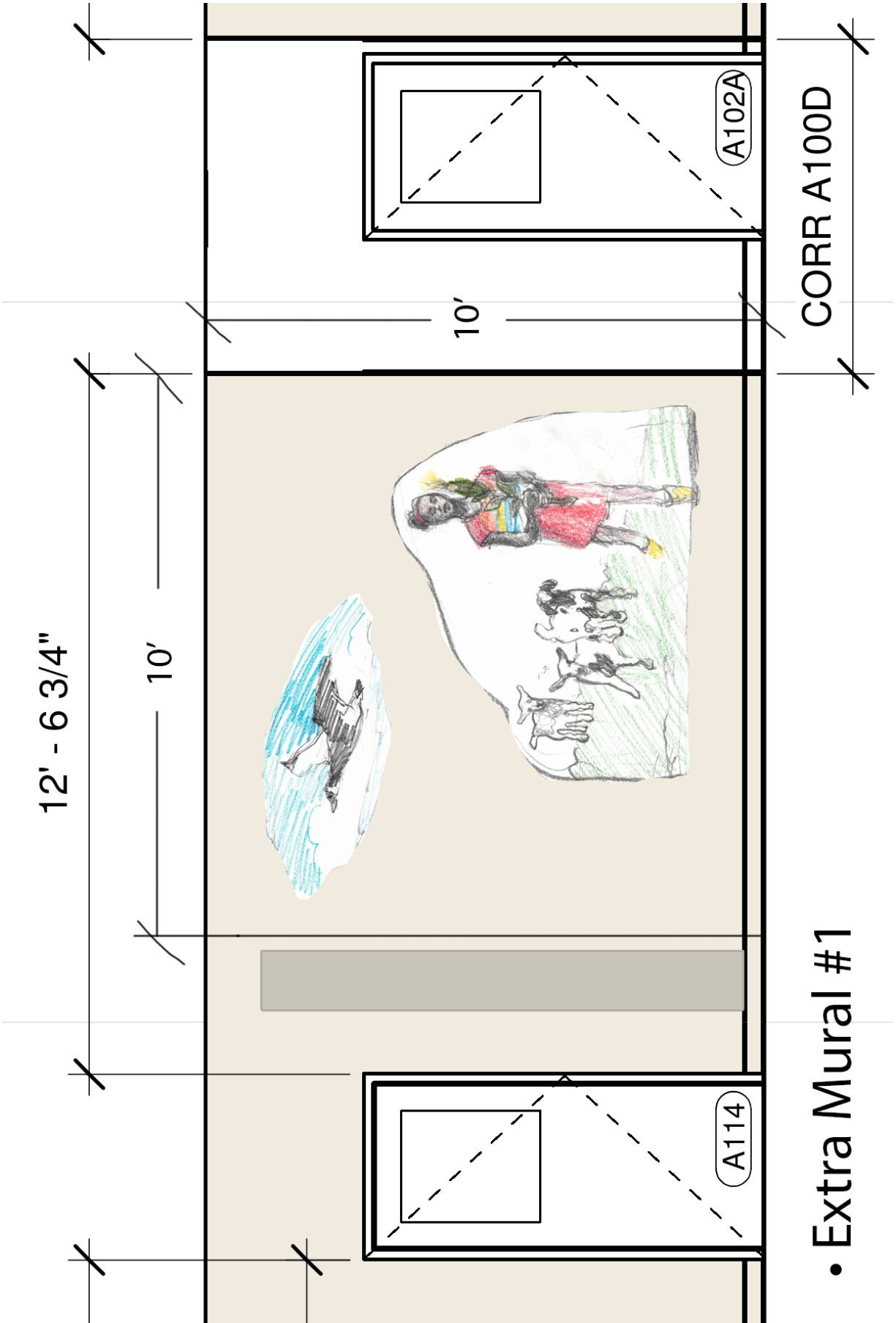

• Extra Mural #1

 Monmouth Elementary/Middle School Percents For Arts Proposal

- **Additional Mural #2** (Above and Below Lake Scene). This large shaped panel would expand on the first Lake Landcape with Canoe, Mural #2 above, but give a view of below and above the water. Elements from the Mural #2 would be seen from different vantage points and expand own our nature bathing theme.

BUDGET for Additional Mural #2

Design Set-Up Fee to create final drawings and transfer to panels

80 hours @ \$25 pr/hr -\$500.00 divided equally between each Artist

Peter Walls - \$ 250.00

David Hurley - \$ 250.00

4 sheets 1/2" One side Paper Coated MDO - \$52.75 each (as of 8/13/20)

- \$ 211.00

2 Gallons INSLX - STIX latex/epoxy primer - \$54.01 each (as of 8/13/20)

- \$ 108.02

2 Gallons Liquitex Gloss Acrylic Varnish. - \$100.33 each (as of 8/13/20)

- \$ 200.66

14 Quarts of Benjamin Moore Aura 100% Acrylic Interior Coating - \$36.91 each

- \$ 516.74

50 Tamper Proof Soft edge Hangers/fasteners Screws

- \$ 15.00

Labor (preparation, painting of panels)

- \$ 4800.00

divided equally between each Artist

Peter Walls - \$ 2400.00

David Hurley - \$ 2400.00

1 Day - Delivery and Installation

- \$ 300.00

** Does not include an on-site maintenance for verification of screw placement **

Total - \$ 6651.42

** \$ 3325.71 per Artist

Monmouth Elementary/Middle School Percents For Arts Proposal



• Extra Mural #2

 Monmouth Elementary/Middle School Percents For Arts Proposal

• **Additional Mural #3** (Apple Pickers). This large shaped panel would be the last before entering the gymnasium vestibule. A large apple tree at the center of it s composition would have an apple picker on a ladder with a child below walking towards the viewer.

BUDGET for Additional Mural #3

Design Set-Up Fee to create final drawings and transfer to panels

80 hours @ \$25 pr/hr -\$500.00 divided equally between each Artist

Peter Walls - \$ 250.00

David Hurley - \$ 250.00

4 sheets 1/2" One side Paper Coated MDO - \$52.75 each (as of 8/13/20)

- \$ 211.00

2 Gallons INSLX - STIX latex/epoxy primer - \$54.01 each (as of 8/13/20)

- \$ 108.02

2 Gallons Liquitex Gloss Acrylic Varnish. - \$100.33 each (as of 8/13/20)

- \$ 200.66

18 Quarts of Benjamin Moore Aura 100% Acrylic Interior Coating - \$36.91 each

- \$ 664.38

50 Tamper Proof Soft edge Hangers/fasteners Screws

- \$ 15.00

Labor (preparation, painting of panels)

- \$ 4800.00

divided equally between each Artist

Peter Walls - \$ 2400.00

David Hurley - \$ 2400.00

1 Day - Delivery and Installation

- \$ 300.00

** Does not include an on-site maintenance for verification of screw placement **

Total - \$ **6799.06**

** \$ 3399.53 per Artis

Monmouth Elementary/Middle School Percents For Arts Proposal

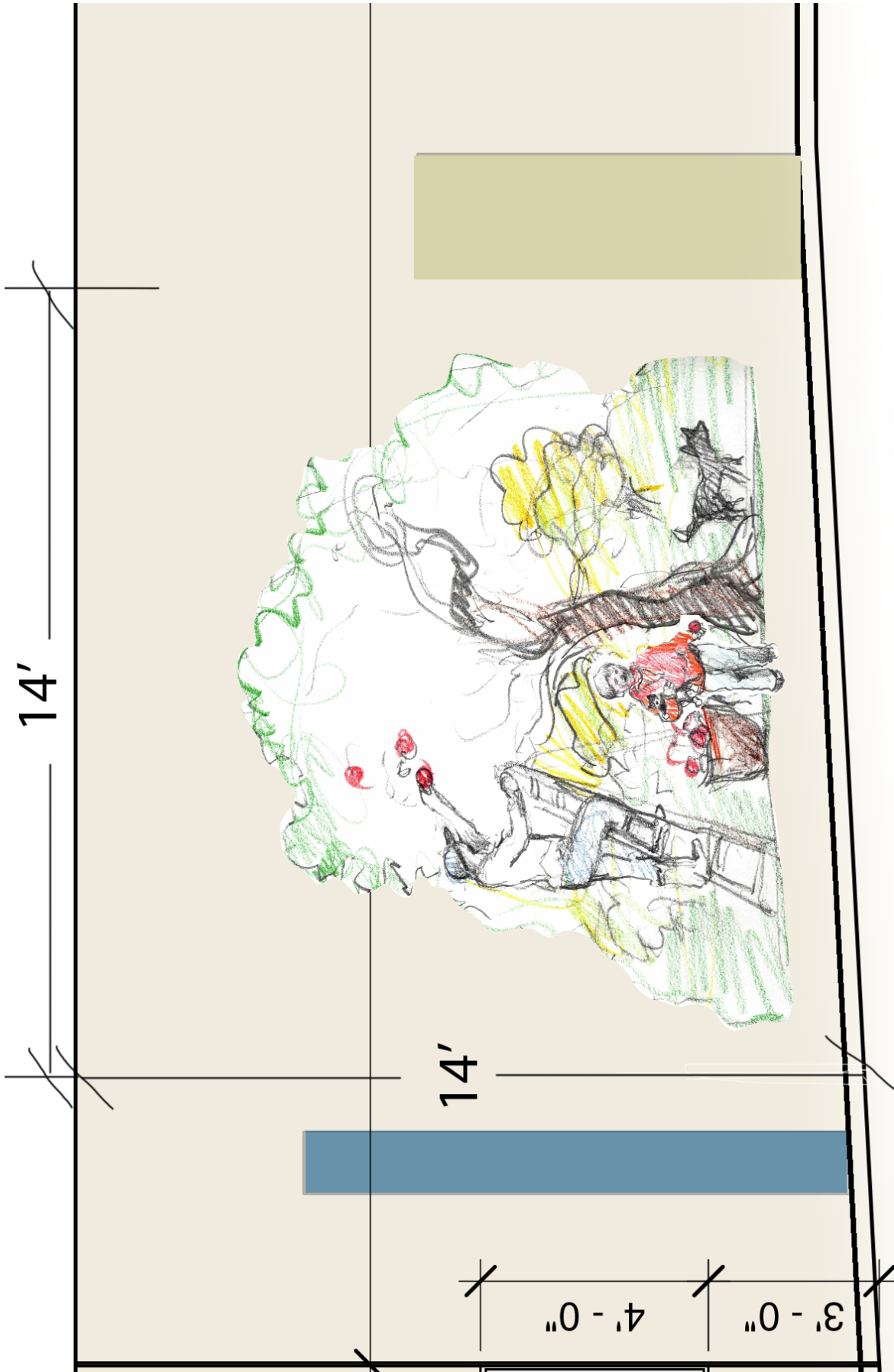

• Extra Mural #3